

58-59



ANNUAL REPORT
of the
Committee of Management
of the
BALLARAT AND DISTRICT
BASE HOSPITAL.

BALLARAT AND DISTRICT BASE HOSPITAL

(INCORPORATED)

OFFICE-BEARERS, 1953-1954

President : M. B. JOHN, Esq.

Vice-Presidents : F. E. V. DUNCAN, Esq. S. E. ABRAHAM, Esq.

Hon. Treasurer : S. E. ABRAHAM, Esq.

Committee of Management :

L. MADDERN, Esq. (Govt. Nominee).

Dr. W. A. SLOSS

Dr. A. C. H. SALTER

H. H. JEPHSON, Esq.

J. McKAY, Esq.

E. G. LUDBROOK, Esq.

J. H. HEINZ, Esq.

R. HUMPHREYS, Esq.

R. A. MUST, Esq.

H. C. EVANS, Esq.

H. C. TIPPETT, Esq.

H. M. WHITE, Esq.

Manager and Secretary : J. L. PLUMMER, J.P., F.I.H.A., F.I.H.S. (Vic.)
(Resigned 31/12/53.)

A. E. MILLER, A.A.S.A., A.I.H.A., A.I.H.S.
(Appointed 1/1/54.)

Assistant Manager and Secretary : B. J. MULGREW, A.A.S.A., A.C.I.S.

Honorary Solicitors : Messrs. CUTHBERT, MORROW, MUST & SHAW.

Auditors : Messrs. DRISCOLL, McIVOR & CO., and J. B. CORBET, A.A.S.A.

MEDICAL STAFF

Medical Superintendent :

Mr. J. C. DICK, L.R.C.P. & S., Edin., L.R.F.P. & S., Glas., F.R.C.S., Edin.

Resident Medical Officers :

Dr. J. M. HERCULES, M.B., B.S.
(Resigned 13/12/53.)

Dr. G. H. MACDONALD, M.B., B.S.
(Resigned 14/12/53.)

Dr. J. W. DODGSHUN, M.B., B.S.
(Resigned 25/1/54.)

Dr. J. K. McCOLL, M.B., B.S.
(Resigned 1/1/54.)

Dr. R. G. GUYMER, M.B., B.S.
(Resigned 18/1/54.)

Dr. J. W. HILL, M.B., B.S.
(Appointed 29/12/53.)

Dr. H. A. MEREDITH, M.B., B.S.
(Appointed 18/1/54.)

Dr. O. McK. COLTMAN, M.B., B.S.
(Appointed 18/1/54.)

Dr. R. C. KERR, M.B., B.S.
(Appointed 24/1/54.)

Dr. D. W. RANKIN, M.B., B.S.
(Appointed 24/1/54.)

Radiologist :

Dr. HEATHER DICK, M.B., B.S., Syd., D.M.R.E., Camb., F.C.R. (Aust. & N.Z.)

Clinical Supervisor and Pathologist : Dr. R. J. RIDDELL, M.B., B.S., D.T.M. & H., Lond.

Anaesthetist :

Dr. KATHLEEN BLOTT, M.B., Ch.B. (Bristol), D.A. (R.C.S. Eng.) (Appointed 9/2/54.)

NURSING STAFF

Matron : Miss J. M. LANGHAM, A.R.R.C.

Assistant Matron : Miss J. BEVERLEY.

Tutor Sister : Miss J. E. HARRIS, S.T.D. (London).

Assistant Tutor Sister : Mrs. V. NYULASY. (Appointed 5/1/54.)

Home Sister and Midwifery Tutor Sister : Miss M. SHALLEY.

Eildon House Sister in Charge : Miss P. O'KEANE.

OTHER OFFICERS

Speech Therapist : Miss M. E. BRIGGS, Vic. Dip., S.T.

Physiotherapists : Miss M. M. SMALL, Dip. A.P.A. Miss V. J. GREEN, M.C.S.P.

Pharmacists :

Mrs. C. DE CARRO, Ph.C., M.P.S.

Miss B. HOMBURG, Ph.C., M.P.S. (Resigned 5/12/53.)

Miss L. SCALLY, Ph.C., M.P.S. (Appointed 22/2/54.)

Radiographer :

Miss M. McDONALD (Resigned 9/12/53). Miss K. MATHER (Appointed 4/1/54).

Engineer : W. CHURCHILL, M.I.M.E., M.I.H.E. Assistant Engineer : G. PEET.

Pathological Technician : W. P. T. SORRELL, M.S.R., D.M.L.T.

Dietitian :

Miss W. M. CAMPBELL (Resigned 6/11/53). Miss S. McDONALD (Appointed 25/1/54).

House Supervisor : Mrs. M. FOYSTER.

BALLARAT AND DISTRICT BASE HOSPITAL (INCORPORATED)

HONORARY PROFESSIONAL STAFF, 1953-1954.

Chairman : Dr. B. A. BAKER, M.B., B.S. (Melb.).

Honorary Consulting Surgeons :

Dr. W. A. SLOSS, M.B., et Ch.B., F.R.C.S. (Edin.), F.R.A.C.S., J.P.
Dr. E. A. GUYMER, M.B., B.S., F.R.C.S. Dr. H. PEARCE, M.B., B.S. (Melb.).
Mr. W. R. GRIFFITHS, M.B., B.S. (Melb.), F.R.C.S. (Edin.), F.R.A.C.S., M.R.C.O.G.

Honorary Consulting Physicians :

Dr. A. C. H. SALTER, M.B., et Ch.B. (Melb.).
Dr. G. T. JAMES, B.A., M.D., B.S., F.R.A.C.P.

Honorary Consulting Obstetrician :

Mr. W. R. GRIFFITHS, M.B., B.S. (Melb.), F.R.C.S. (Edin.), F.R.A.C.S., M.R.C.O.G.

Honorary Consultant E.N.T. Surgeon :

Dr. S. HILLS, M.B., B.S. (Melb.).

Honorary Surgeons :

Mr. M. ROBINSON, M.B., B.S. (Melb.), F.R.C.S. (Eng.), F.R.A.C.S.
Mr. H. D. DRURY, M.B., B.S. (Melb.), F.R.C.S. (Eng.), F.R.A.C.S.
Mr. D. B. SKEWES, M.B., B.S., F.R.C.S. (Edin.).

Honorary Physicians :

Dr. E. R. G. SHEIL, B.Sc., M.B., B.S. (Melb.). Dr. B. A. BAKER, M.B., B.S. (Melb.).
Dr. D. ALEXANDER, M.B., B.S. (Melb.), M.R.A.C.P., M.D. (Melb.).

Honorary Anaesthetists :

Dr. P. G. SMITH, M.B., B.S. (Melb.), M.F.A., R.A.C.S. (Resigned November, 1953.)
Dr. G. PERN, E.D., M.B., B.S., M.F.A.R.A.C.S.
Dr. W. A. PRYOR, M.B., B.S. (Adel.), F.F.A., R.A.C.S.

Honorary Pediatrician :

Dr. C. E. RICHARDSON, M.B., B.S. (Melb.).

Honorary E.N.T. Surgeon :

Mr. C. L. COGHLAN, M.B., B.S. (Melb.), D.L.O. (Melb.), F.R.A.C.S. (Resigned September, 1953.)

Honorary Urologist :

Mr. G. R. DAVIDSON, M.B., B.S. (Melb.), F.R.C.S. (Edin.), F.R.A.C.S.

Honorary Gynaecologist :

Dr. W. T. GREENING, M.D., B.S. (Melb.).

Honorary Obstetrician :

Dr. W. L. SLOSS, M.B., B.S. (Melb.), M.R.C.O.G.

Honorary Ophthalmologist :

Dr. J. E. THOMAS, M.B., B.S., B.Sc., B.V.Sc., B.Agr.Sc., Ph.C. (Melb.), D.O. (Lond.).

Honorary Diabetic Physician :

Dr. J. S. T. STEVENS, M.B., B.S. (Melb.), M.R.C.P. (Lond.).

Honorary Outpatient Physician :

Dr. J. S. T. STEVENS, M.B., B.S. (Melb.), M.R.C.P. (Lond.).

Consultant Optometrists : Messrs. WASTELL & CUTTER.

Honorary Dental Surgeons :

Mr. J. V. DALE, B.D.Sc., L.D.S. Mr. F. J. A. FAVALORO, B.D.Sc., L.D.S.
Mr. P. R. RICHARDS, B.D.Sc., L.D.S. Mr. J. H. REDMAN, B.D.Sc., L.D.S.

BALLARAT AND DISTRICT BASE HOSPITAL
(INCORPORATED)
(Established 1856)

THE NINETY-SEVENTH ANNUAL REPORT
OF THE COMMITTEE OF MANAGEMENT
FOR THE YEAR ENDED MARCH 31, 1954



To the Contributors and Life Governors.

Ladies and Gentlemen,—

Your Committee of Management has much pleasure in submitting to you the Ninety-Seventh Annual Report and Financial Statements for the year ended 31st March, 1954.

As the Hospital nears its centenary, the time is appropriate to direct our thoughts back along the years and to think with warm admiration of those, many of whom are today unknown, without whose aid and inspiration, our Hospital, as we know it today, could not have been so securely established in our community and in the minds of all those whom it now serves.

It is well, too, to look ahead to the future of this, our rapidly developing country, and to the future of Ballarat and district in particular.

The Ballarat and District Base Hospital, in keeping abreast of the service demands with which it is required to cope and which it will face in the future, will undoubtedly take its place as one of the foremost hospitals in not only Victoria, but the whole of Australia.

Present-day sociological trends require that Hospitals such as yours shall be, in fact, comprehensive health and educational centres. The Ballarat and District Base Hospital accepts this role, which it already fills with notable success.

The service demands made by the community's sick, injured, and those requiring aid, necessitate a highly specialised and complex structure of diversified skills. This, in turn, dictates that the Hospital's financial economics shall be critically examined in order that adequate funds for all needs will be available.

The following statistics clearly illustrate the extent of service given and some of the factors associated with its provision :

In-Patients accommodated and treated	5,116
Out-patients' attendances (all departments)	57,444
Babies born	1,012
Operations performed	1,280
X-ray films used	17,003
Pathological tests performed	7,964
Physiotherapy treatments	7,252
Meals served	355,685
Lbs. of laundry processed	605,729
Tons of coal consumed	1,576
Gallons of fuel oil consumed	29,018
Staff employed	368
Daily average of in-patients	208.6
Running cost for year to 31/3/54	£261,307

VISIT TO BALLARAT BY
HER MAJESTY QUEEN ELIZABETH II

Although it was not possible to hope, owing to the limited time available, that Her Majesty and His Royal Highness The Duke of Edinburgh might visit the Hospital during the Royal Visit on 6th March, 1954, it was, in retrospect, a stirring thought : "Our Queen and the Duke passed this way."

The Hospital was mindful of its responsibilities, and a comprehensive plan, in preparedness for possible major accidents affecting some of the many thousands of visitors to Ballarat on the historic occasion, was ready for implementation.

Happily, the day was unmarred by any unfortunate happenings, and this Committee pays tribute to all the civic and voluntary bodies associated with the organization of this memorable event.

BUILDING DEVELOPMENT : It is most encouraging to see the Hospital progressively developing along the lines envisaged when, in 1945, the then Governor-General, H.R.H. The Duke of Gloucester, set in position near Yuille House the stone which records that, as a memorial to the newly-won Peace, after War, a new Hospital would be erected in place of the old buildings which had served faithfully and well since the Hospital's earliest days.

From the efforts of those who saw the need have arisen such buildings as the fine new Nurses' Home, Yuille House, and the Boiler House. In addition, a new building, for kitchens, stores, workshops, dining rooms and associated services, has been commenced, and work is proceeding very satisfactorily.

The citizens of Ballarat and district are to be congratulated on their support for these developments, and appreciation is due to the State Government and the Hospitals and Charities Commission for acceptance of the greater part of the financial responsibilities for these works.

Much will always remain to be done, because the Hospital which would continually widen its scope of community service can never really "stand still"—suffice to say that your Hospital's building programme involves years of forward planning, as has been so necessary for that which has already been achieved.

OPENING OF "YUILLE HOUSE" : The Opening Ceremony of the new Yuille House building took place on Sunday, 2nd May. Yuille House has 100 beds for the accommodation and treatment of Tuberculosis and other Infectious Diseases sufferers.

This accommodation is an acquisition to Ballarat, and it is well worthy of note that the possibility of contracting Tuberculosis in a modern and properly conducted sanatorium or chalet is very much less than in one's daily life elsewhere.

The Minister of Health, the Honorable W. P. Barry, M.L.A., officially declared Yuille House open. The ceremony was attended by representatives of the Yuille family, descendants of William Cross Yuille, the founder of Ballarat, and in whose honour the building was named.

NEW SERVICES :

Peter MacCallum Clinic (of the Cancer Institute, Melbourne) : Implementing the policy of providing the widest possible range of specialist services for which the

need exists, arrangements were made for the establishment of a Peter MacCallum (Cancer) Clinic at the Hospital. This was inaugurated on 2nd February, 1954, under the charge of Dr. Kaye Scott, an eminent specialist in this sphere.

The Clinic has proved its undoubted worth. The establishment of these Clinics throughout the country, as is the policy of the Cancer Institute, is probably one of the finest developments in Victoria's "health" history.

The Clinic is conducted on the first Friday in each month, the patients, whose numbers are constantly increasing, being referred thereto by their district medical practitioners.

Orthoptic Clinic: This Clinic will soon commence functioning, its purpose being to determine the nature and degree of "squint" in children's eyes, and to advise on exercises and treatment designed to overcome the disability.

This Clinic will be under the control of Miss D. Mann, of Melbourne, who will visit approximately monthly.

Psychiatric Clinic: Following his return to Ballarat, and appointment as Honorary Psychiatrist at this Hospital, Dr. E. L. Roberts will shortly recommence the services of the Psychiatric Clinic.

This most important Clinic will quietly and very effectively meet a definite and tremendously humanitarian need.

Ear, Nose and Throat Clinic: Your Committee knows that a recommencement of activities by the Ear, Nose and Throat Clinic is much needed, and therefore every effort in order to bring this about is being made.

It is felt that a brief summary of specialist services available at the Hospital would be of interest. Apart from the specialist honorary Medical, Surgical, Maternity and Dental Services, the under-mentioned Clinics and Departments are firmly established or are being developed:

X-ray Department	Speech Therapy Clinic
Pathological Department	Diabetic Clinic
Physiotherapy Department	Peter MacCallum Clinic
Ante Natal Clinic	Blood Bank
Chest Clinic	Psychiatrist Clinic
Orthoptic Clinic	Pharmacy
Thoracic Surgery Unit	

FINANCE: It will be apparent that provision of all the services referred to, added to the daily in-patient bed costs, involves heavy expenditure.

The total costs for the year to 31st March, 1954, were £261,307 and total income amounted to £254,415, resulting in a deficiency of £6,892.

Certain factors have produced this result, despite the introduction of "Service Fees" of 18/- per day chargeable to public patients. However, adjustment within the ensuing year of Governmental payments promises to offset the deficit to which reference has been made.

The number of patients who have obtained membership of organizations, which membership will also entitle them to receive Commonwealth Hospital and Medical Benefits, continues to grow. Such benefits largely recover for patients a great part of hospital accommodation expenses, also of the fees for operations, and special services such as X-ray and Pathology tests. This reference is made in view of the fact that it has a direct relationship to the ready payment by patients of Hospital fees for services rendered.

Of the total income of £254,415 for the year, £151,769 (59.6%) was derived from State and Commonwealth Government sources; £90,772 (35.6%) from patients' Fees, including Eildon House; the balance of £11,874 (4.8%) coming from donations, Auxiliary efforts and fund-raising functions, unconditional legacies and bequests individually not in excess of £100, and miscellaneous payments.

The Committee's deep gratitude for all voluntary support is warmly expressed.

HONORARY PROFESSIONAL SERVICES: Public hospital medical, surgical and maternity services have, traditionally, been provided by the voluntary work of medical practitioners who have sought, and been appointed to, honorary positions on hospital staffs.

The value of the work performed in this capacity has always been, and remains, incalculable. On behalf of the community, and of the Committee elected to serve its interests, sincere appreciation for all the highly-skilled, thoughtful and time-consuming efforts made is warmly expressed to the Hospital's Honorary Professional Staff.

During the year Mr. D. Skewes, Dr. D. Alexander and Dr. J. S. T. Stevens were appointed as Honorary Surgeon, Honorary Physician and Honorary O.P. Physician respectively. These gentlemen are congratulated on their appointments.

Mr. W. R. Griffiths and Dr. G. T. James retired from their active honorary appointments and were appointed to the Honorary Consultant Staff. This opportunity is taken to record whole-hearted appreciation for the work of these gentlemen over a lengthy period.

Mr. C. L. Coghlan relinquished his appointment as Honorary Ear, Nose and Throat Surgeon, and Dr. P. G. Smith resigned his appointment as Honorary Anaesthetist during the year. Sincere appreciation for the efforts of these gentlemen is gratefully expressed.

Special reference is gratefully made to the Medical Lecturers who have given so freely of their time to lecture to nursing trainees.

The interest so demonstrated is invaluable to the Hospital, not only because of the wealth of lecture information, but for its stimulation to the trainees.

STAFF: -

RESIGNATION OF MANAGER.

The resignation, from Managership of the Hospital, of Mr. J. L. Plummer, which became effective at 31st December, 1953, was accepted with very great regret.

Much of that which has been recorded in this Report's comments on "Building Development" will remain as testimony to Mr. Plummer's outstanding vision, ability and untiring effort.

The high regard in which the Ballarat and District Base Hospital is held, both near and far, is, in large degree, attributable to its Administrator of the past nine years.

Mr. Plummer's splendid interest and fruitful work in the manifold aspects of Hospital Administration earned for him a high place in Australia's hospital affairs.

He carries with him the best wishes of all associated with the Hospital for success and happiness in his new sphere.

Administration : Mr. A. E. Miller, A.A.S.A., A.I.H.A., A.I.H.S., previously Manager of the Latrobe Valley Community and the Echuca District Hospitals, was appointed to the position vacated by Mr. J. L. Plummer.

Following his appointment as Manager of the Stawell District Hospital, Mr. R. K. McMullin, formerly Chief Clerk, was replaced by Mr. J. Nice.

Pathology Department : The Hospital greatly regretted the resignation of Dr. R. J. Riddell (Pathologist), following his appointment to the Austin Hospital, Heidelberg. Dr. Riddell had been Pathologist for the past four years. Steps to replace Dr. Riddell are being taken; meanwhile, Mr. Sorrell and assisting staff are continuing the work in this highly important field, and the Hospital's thanks are extended to them.

Full-time Medical Staff : In December 1953 and January 1954, the following Resident Medical Officers commenced their post-graduate year at the Hospital: Drs. O. McK. Coltman, J. W. Hill, R. C. Kerr, H. A. Meredith and D. W. Rankin.

These gentlemen, under the guidance of Mr. J. C. Dick (Medical Superintendent) have settled down well to the requirements of their appointments.

Appointment of Full-time Anaesthetist : An important development, in line with the general trend in relation to provision of anaesthetic services for public patients, was the appointment, in February 1954, of Dr. Kathleen Blott as full-time Anaesthetist on the recommendation of the Honorary Anaesthetists.

The position concerning anaesthetics for public patients in provincial hospitals is not capable of easy resolution, therefore your Committee is devoting much time and thought to the subject. Meantime, Dr. Blott is rendering valuable service to the Hospital and the patients.

Nursing Service : The Hospital, and therefore those requiring its services, has been well served by all staff during the year under review.

It is a pleasure and privilege to record that all members of the Nursing Staff, trained and trainee members alike, have, under the Matron, Miss J. M. Langham, A.R.R.C., faithfully discharged their trust, the duties of which bring its members into closest touch with all those requiring relief, succour, sympathy and understanding.

The 10th Annual Graduation Ceremony, held in the Alfred Hall, was a most enjoyable occasion, marking, as was its purpose, the successful conclusion of comprehensive training courses for 47 graduates.

Dr. J. H. Lindeli, Chairman of the Hospitals and Charities Commission, was the Guest Speaker. His well-chosen remarks were directed towards the new graduates, and should prove of very great assistance in guiding their careers which lie ahead.

The graduates listed hereunder were presented with their Hospital badges and Certificates of Training :

General Nursing : Sisters Y. Cornthwaite, Z. Coleman, G. Oberon, R. McDonald, J. Knox, J. Donohue, E. Middlemiss, M. O'Connell, M. Coutts, M. Wheeler, M. M. Kelly, N. McMichael, M. Bineham, A. Tyler, M. Donnelly, N. Wright, P. McIvor, E. Nimmons, V. Sebire, B. Austin, P. Cooke, I. Dick, V. Galvin, V. Murphy, M. O'Neill, H. Seers, E. Wilson, B. Kelly, B. Wilson and R. Gillett.

4th Year Graduates : Sisters H. Adair, J. Ladyman, J. Buckland, E. Wing, P. Haintz and K. Curnow.

Midwifery : Sisters E. Orr, J. Jackson, M. Wilks, P. Gellatley, A. Paterson, G. Cameron, D. Bowker, J. Ryan, H. Holden, L. Molloy and J. Ross.

The following were Prize-winners for the year, and their awards were presented by Dr. Lindell :

Preliminary School Examinations : Nurse J. Dyson.
Surgical Examination : Nurse W. Archibald, Nurse M. Kuhne.
Medical Examination : Sister E. Nimmons.
Urology Examination : Sister M. McMichael.
Ear, Nose and Throat Examinations : Nurse W. Archibald.
Ophthalmology Examinations : Sister E. Nimmons.
Children's Nursing Examination : Nurse T. Harlock.
Efficiency in Children's Nursing : Sister P. Cooke.
Highest Marks Throughout Training : Sister E. Nimmons.
Best Practical Nursing Throughout Training : Sister E. Nimmons.
Matron's Prize for Efficiency and Reliability : Sister M. O'Neill.

During the year Sister G. Cameron was appointed Assistant Charge Sister to Ward 4 (Maternity), in place of Sister N. McLachlan, who departed to Ocean Island.

Sister J. Sharp was appointed Charge Sister of Ward 5 in place of Sister A. Cooper who, after sick leave, joined the Relieving Staff.

Sister F. Ferguson was appointed Charge Sister of Ward 7 in place of Sister M. M. Williams, who subsequently spent six months overseas and is now in charge of Ward 9.

Sister B. Vickers was appointed to the charge of Ward 10.

Sister J. McDonald resigned as Senior Theatre Sister to proceed overseas, and has since returned to that position. Sister O. Bainbridge assumed Sister McDonald's duties in the latter's absence.

The loyal service of the Hospital's Charge Sisters in all sections is one of the greatest factors contributing to the Hospital's record of successful service.

Sister Tutor Staff : Sister V. Nyulasy was appointed as Assistant Sister Tutor for the Nurses' Training School.

Congratulations are expressed to Sister J. A. Harris on her election as President of the Sister Tutors' Association of the Victorian College of Nursing.

Pharmacy : Following Miss B. Homburg's departure from Ballarat, Miss L. Scally, Ph.C., M.P.S., was appointed to the staff of the Pharmacy which is increasingly busy with Pharmaceutical Benefit involvements.

X-ray Department : This Department continues to expand its service, under the control of Dr. Heather Dick. Dr. Dick was granted leave from May until September 1953 to attend the Radiological Congress at Copenhagen, Denmark.

Congratulations are extended to Miss Kira Mather, who won the Kodak Prize for the best radiography candidate in Australasia at the recent Final Examinations. Miss Mather has been promoted Radiographer in place of Miss M. McDonald who departed to Melbourne at the end of 1953.

Dietitian : Towards the end of 1953 Miss W. Campbell, Dietitian, was appointed to a similar position at the Footscray and District Hospital. Miss S. McDonald was appointed to the vacancy and is continuing the splendid work formerly undertaken by Miss Campbell.

The Committee's appreciation of the loyal service of all Staff is warmly expressed, and only considerations of space in this Report prevent detailed reference to the many sections of the Hospital.

"MARY-HELEN" AUXILIARY: The "Mary-Helen" Auxiliary celebrated the 25th Anniversary of its inauguration during the year.

This fine group of ladies, working constantly in support of the Hospital's endeavours, has again this year rendered splendid service.

The Committee expresses its thanks to the Auxiliary, and to all those members, both former and present, who have contributed so well and faithfully to the Auxiliary's objectives of service to others.

Valuable items of linen have again been provided, and the cost of the special Christmas Dinner and Easter Cheer for patients was borne by the Auxiliary.

The opportunity is taken to express congratulations to Mrs. J. C. Rowe on her successful year of office as President, to say "Bon Voyage" for Mr. and Mrs. Rowe's impending visit overseas, and to thank Miss E. Simpson for another fine and loyal year as Secretary.

It was pleasing to note that the opportunity of attending the Official Ladies' Luncheon to Her Majesty was extended to a representative of this Hospital's Auxiliary workers. Mrs. Rowe was chosen by the ladies of these groups to be their representative.

HOSPITAL YOUNGER SET: The view is often expressed that community service responsibilities are not widely accepted by the younger folk of today.

While the circumstances of prevailing conditions appear to lend force to the view expressed, it is true that the calls of numerous "Service" groups (all doing an excellent job) must have an effect on the volume of support accorded particular causes.

From the foregoing it will be apparent that it is extremely encouraging to note that the Hospital Younger Set has again rendered splendid help, particularly to the kiddies who have been patients in the Children's Wards.

The Committee's appreciation is warmly expressed to the young women of the Hospital Younger Set, the President, Miss (Nurse) A. Ring, and the Secretary, Miss G. Lawry.

SUNSHINE CIRCLE: When the patient's day is long and convalescence seems slow and irksome, there is nothing so cheering to him or her as the revelation that someone other than their own folk is happy to come along and, in truth, to bring a lot of brightness to the day.

The regular attendance of the splendid band of ladies, known collectively as the "Sunshine Circle," to distribute reading matter to the patients, is a shining example faithfully shown now for 34 years, of kindly thought for others.

The Committee of Management expresses its deep appreciation to the Sunshine Circle's President (Miss A. Draffin), the Secretary (Miss I. Allan) and all members.

HOSPITAL RAILWAY AUXILIARY: Although not active at present, the Hospital Railway Auxiliary has a splendid record of service to the patients.

The annual Christmas Morning visit was a particularly warming gesture, and it is hoped that circumstances will soon enable a resumption of activities by the men of the Railways.

HONORARY LIFE GOVERNORS: As a mark of appreciation for valuable support, the following Honorary Life Governors were appointed during the year: Mrs. E. Knowles, Mrs. F. Penney and Mr. A. J. Saph. Congratulations are expressed to the recipients of these well-merited awards.

COMMITTEE: Messrs. R. Humphreys, H. H. Jephson, and J. McKay retire by effluxion of time, and, being eligible, are available for re-election.

As President during the past two years, I here gratefully record my sincere appreciation to all members for their unfailing interest and support at all times.

REPATRIATION WARD: In the latter part of the year under review, the Repatriation Department advised the Hospital of its intention to terminate the existing agreement whereby a separate Repatriation Ward was provided at the Hospital.

This decision became effective at 31st March 1954, and since that time the Hospital has made every effort to provide accommodation for acutely-ill Repatriation patients.

Many meetings, in Melbourne and Ballarat, at the Hospital and elsewhere, have taken place, and it is hoped that satisfactory arrangements will be finally agreed upon by the parties directly concerned.

GENERAL: Generally, realising that the Hospital is splendidly assisted by a very great number of persons and organizations, too numerous to mention specifically, may I ask that all will kindly accept the Hospital's whole-hearted gratitude for their support, with the hope that it may long continue.

At the same time I would like to make mention of the Ballarat Travellers' Social Club, because this splendid group depends initially for its source of funds on the general public. The fine sum of £1,789/12/2 was handed to the Hospital during the year, and this has been invested pending its expenditure, with the Club's approval, on specified projects.

The employees of the Lifeguard Milk Company have continued their extremely welcome support, and this year sponsored the provision of apparatus which will enable silver to be recovered from the X-ray Department's film developing processes.

Sincere thanks are also expressed to the Proprietors and Management of the Garden City Flour Mill, Ballarat, for their practical assistance in donating flour for cooking purposes.

The very fine response of blood donors, when called, is an instance of what is very truly, life-saving aid. No expression of thanks adequately records the debt of gratitude to blood donors.

The children of Ballarat have again demonstrated their interest in the Hospital by their egg collections, which totalled 1730 dozen. Appreciation to all parents, teachers and the children is sincerely recorded and expressed.

Finally, in reviewing the activities of the year which has passed, it is well to look also to the years which lie ahead. There are many building problems to be faced, including that of additional accommodation for non-public patients.

I believe that the Ballarat and District Base Hospital has a very important part to play in the hospital affairs of this part of the State, particularly in the light of development of "regional" medical and hospital services.

I believe, also, that your Hospital is becoming equipped, both from the physical standpoint, and already prepared, by quality and scope of service rendered, to accept and discharge this onerous trust.

On behalf of the Committee of Management,

M. B. JOHN, President.

In One Year

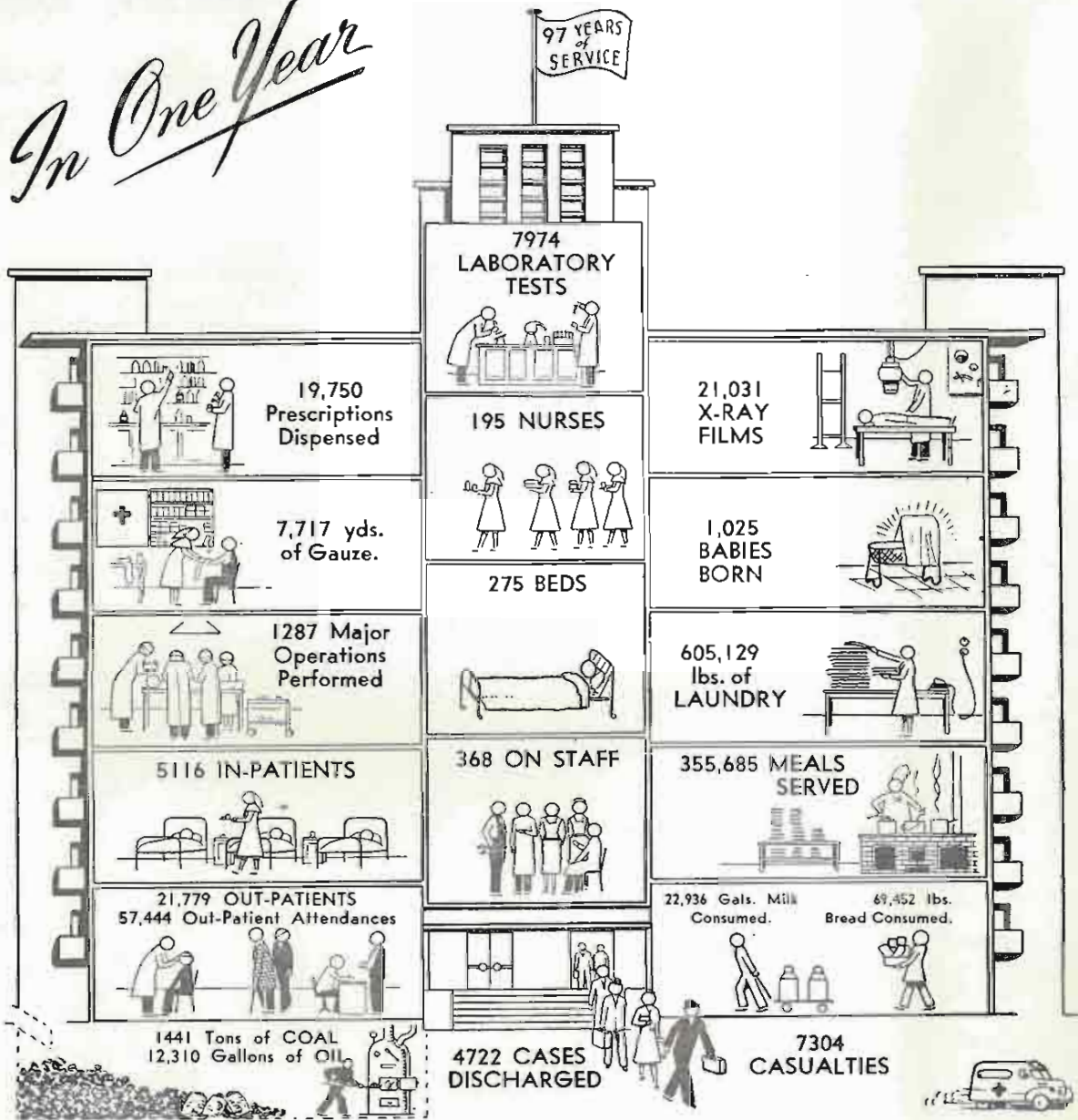

COMMODITIES CONSUMED

Meat	68,235 lbs.
Bacon	3,097 lbs.
Fish	5,938 lbs.
Butter	11,968 lbs.
Eggs	11,475 dozen
Flour	12,591 lbs.
Sugar	21,598 lbs.
Jam	5,306 lbs.
Vegetables	189,782 lbs.
Fruit	50,752 lbs.

STATISTICS

Patients in Hospital, 1/4/53	218
Admitted during year	4,896
Total Inpatients Treated	5,116
Patients Discharged, etc.	4,722
Patients in Hospital, 31/3/54	196
Daily Average	208.6
Outpatients (Persons)	21,779
Outpatients (Attendances)	57,444
Av. Cost Per Inpatient Treated	£45/8/-
Av. Cost Per Day Per Inpatient	£3/1/-

BALLARAT AND DISTRICT BASE HOSPITAL

(INCORPORATED)

BALANCE SHEET AS AT 31st MARCH, 1954.

GENERAL FUNDS.

Adjusted to nearest £

	LIABILITIES.		ASSETS.	
CURRENT LIABILITIES :				
Maintenance Bank Overdraft	£23,236		Cash in Hand	£79
Sundry Creditors	7,719		Cash at Bank	991
Expenses Accrued	3,367		Stores on Hand	11,756
Fees Paid in Advance	1,237		Income Accrued	18,432
Suspense Account	5		Pharmaceutical Benefits	1,225
	<u>£35,564</u>		Patients' Fees Outstanding	18,835
Services Building Bank Account Overdraft	10,964			<u>£51,318</u>
			Mortgage	981
HOSPITAL FUNDS :				
Capital	500,421		FIXED ASSETS :	
Accumulated Maintenance Funds	17,647		Land and Buildings	449,639
	<u>518,068</u>		Plant and Machinery	13,014
			Furniture and Fittings	49,644
				<u>512,297</u>
	<u>£564,596</u>			<u>£564,596</u>
ENDOWMENT FUNDS				
Endowment Funds	£22,732		Investments	£22,732
BUILDING AND EQUIPMENT FUNDS.				
Building and Equipment Trust Funds	20,016		Cash at Bank	4,988
Unexpended Capital Gifts	4,988		Building Trust Investments	20,016
	<u>25,004</u>			<u>25,004</u>
SPECIAL FUNDS.				
Patients' Trust Fund	318		Cash at Bank : Patients' Trust	318
Repairs and Replacements: Creditors	311		Stores: Repairs and Replacements	£172
Motor Vehicle Replacement	915		Repairs and Replacements Reserve Investments	139
X-ray Replacement Fund	803			<u>311</u>
Maintenance Reserve (Radio Appeal)	7,566		Investments Held	14,624
Loan Redemption Sinking Fund	5,340			<u>15,253</u>
	<u>15,253</u>			<u>£627,585</u>
	<u>£627,585</u>			<u>£627,585</u>

AUDITORS' CERTIFICATE.

We hereby certify that we have audited the books, vouchers and documents of the Institution and find that the postings are accurately made under their proper headings and that the Statement of Accounts, including the Balance Sheet, are correct. We have inspected the Securities and Insurance Policies, and obtained Bankers' Certificates with respect to the balances represented by assets in the various Statements of Accounts, and found them in order.

DRISCOLL, McIVOR & CO.,
J. B. CORBET, A.A.S.A., Auditors.

BALLARAT AND DISTRICT HOSPITAL
(INCORPORATED)
BALANCE SHEET AS AT 31st DECEMBER 1964
GENERAL

Adjusted to nearest £

LIABILITIES.

CURRENT LIABILITIES :

Maintenance Bank Overdraft	£23,236	
Sundry Creditors	7,719	
Expenses Accrued	3,367	
Fees Paid in Advance	1,237	
Suspense Account	5	
		£35,564
Services Building Bank Account Overdraft		10,964

HOSPITAL FUNDS :

Capital	500,421	
Accumulated Maintenance Funds	17,647	
		518,068
		£564,596

Endowment Funds		£22,732
------------------------------	--	---------

Building and Equipment Trust Funds	20,016	
Unexpended Capital Gifts	4,988	
		25,004

Patients' Trust Fund	318	
-----------------------------------	-----	--

Repairs and Replacements: Creditors	311	
--	-----	--

Motor Vehicle Replacement	915	
X-ray Replacement Fund	803	
Maintenance Reserve (Radio Appeal)	7,566	
Loan Redemption Sinking Fund	5,340	
		15,253

£627,585

ENDOWMENT

BUILDING AND EQUIPMENT

SPECIAL

AUDITORS

We hereby certify that we have audited the accounts of the Ballarat and District Hospital for the year ended 31st December 1964, and that the postings are accurately made under the heading of the Balance Sheet, are correct. We have also obtained Bankers' Certificates with respect to the Cash and Bank Accounts, and found them in order.

BALLARAT AND DISTRICT BASE HOSPITAL

(INCORPORATED)

STATEMENT OF INCOME AND EXPENDITURE

For the 12 months ended 31st March, 1954.

Adjusted to nearest £

EXPENDITURE		INCOME	
To Bread, Butter, Fish, Meat, Milk, etc.	£34,482	From State Government Grant	£125,730
Drugs, Medicines, Ointments, etc.	22,902	Commonwealth Hospital Benefits	26,039
Coal, Electricity, Gas, Linen, etc.	27,448	Municipal Grants and Infectious Diseases Payments	672
Salaries and Wages	165,778	Patients' Fees	90,360
Insurance, Printing, Stationery, Telephone, etc.	5,349	Income from Investments	786
Repairs to Buildings	2,285	Visitors' Fees	2,142
Interest, Rent, etc.	1,252	Sale of Produce, Stores and Refuse	120
Extraordinary Expenditure	1,811	Miscellaneous	1,048
		Annual Subscriptions	1,836
		Proceeds of Entertainments	3,845
		Hospital Sunday	110
		Other Collections and Donations (Kind)	639
		Other Collections and Donations (Cash)	477
		Unconditional Legacies	611
		Deficiency for Period	6,892
	<u>£261,307</u>		<u>£261,307</u>

COMPARATIVE STATEMENT OF INCOME AND EXPENDITURE

in the Maintenance Account during the past five years,
together with Statistics of the work performed in that period.

INCOME

	1949-50	1950-51	1951-52	1952-53	1953-54
Government Grants	£87588	£102195	£128465	£166486	£151769
Municipal Grants, etc.	978	597	970	1035	672
Charitable Contributions	6995	8226	8238	7710	7518
Out-Patients' Fees	13778	14873	21058	23768	23666
In-Patients' Fees	21436	27715	40966	59785	66694
Interest on Investments	681	681	681	681	786
Visitors' Fees	2005	1987	2234	2162	2142
Miscellaneous	2150	1498	953	877	1168
TOTAL INCOME	£135611	£157772	£203565	£262504	£254415

EXPENDITURE

	1949-50	1950-51	1951-52	1952-53	1953-54
Provisions	£16025	£18407	£26464	£31945	£34482
Surgery and Dispensary	13483	13877	15330	16049	22902
Domestic	15756	19293	23638	28301	27448
Salaries and Wages	78303	95555	139428	156964	165778
Miscellaneous and Administration . . .	4235	3219	6146	5639	5349
Establishment Charges	3276	2105	1440	2383	2285
Finance	1218	1048	1440	1055	1252
Extraordinary Expenditure	1400	2684	989	1582	1811
TOTAL EXPENDITURE	£133696	£156188	£214875	£243918	£261307

FINANCIAL POSITION

	1949-50	1950-51	1951-52	1952-53	1953-54
Maintenance Bank Balance	£15622	£20844	£19622	£10381	£30480
(After Payment of Accounts)	o/d.	o/d.	o/d.	o/d.	o/d.
Endowment	21057	22348	22595	22629	22732

STATISTICAL

	1949-50	1950-51	1951-52	1952-53	1953-54
Average Stay (Days)	14.5	14	14.9	15.8	14.88
Daily Average	216.12	212.3	231.5	228.7	208.6
In-Patients	5441	5542	5646	5289	5116
Paid Staff	296	309	343	355	368
Accommodation	208	208	230	230	230
Accommodation (Infectious and T.B.)	45	45	45	45	45
Out-Patients	13049	14989	17431	23605	21779
Out-Patients' Attendances	44874	45716	51002	58869	57444

LEGACIES

The Committee of Management gratefully acknowledges receipt of the following legacies during the year.

The money is being used for furthering the developmental programme and, where possible, to perpetuate the name of the testator in connection with the project to which the money is applied.

Estate of :

ANDERSON, E.	£50 0 0
ANSTIS, M.	118 19 3
CUBLEY, C. A.	31 5 0
ELLWOOD, J. S.	50 0 0
FISHER, R.	25 0 0
GRAHAM, J. A.	104 17 11
GRAYLING, J.	6 4 11
GRUNDY, E.	1278 9 4
HASSALL, T.	139 1 7
McQUEEN, J.	8 18 4
POTTER, A. B.	2250 0 0
ROBERTS, H. H. R.	14 17 0
RODDA, J. P.	1000 0 0
STEVENS, H. P.	1350 0 0
WRIGHT, J.	250 0 0

LIFE GOVERNORS

Bailey, J. R.
 Baird, Rev. J.
 Bartlett, J. C.
 Baxter, J. P. H.
 Bentick, A. H.
 Bickford, Rev. J.
 Blakeley, J. C.
 Biogg, J. Kendrick
 Buck, William

Chaplin, Mrs. W. W.
 Chinney, W.
 Clark, W. L. R.
 Clarke, Lieut. E.
 Coghlan, Mrs. W. J.
 Coles, Mrs. G. J.
 Cook, J.
 Crocker, H. T.
 Cummins, J. M.

Dalgleish, J.
 Douglas, J.
 Draffin, Miss A.

Edwards, H.
 Edwards, W.

Farlow, G. R.
 Fenner, C. S.
 Fenton, J. L.
 Fishwick, Miss D.
 Fitzpatrick, P.
 Flecknoe, Arthur E.
 Foster, H.
 Foster, H. W.

Gardiner, Mrs. J. M.
 George, H. B.
 Gray, H.
 Grenville, A. J.

Hall, R. C.
 Ham, J. J.
 Hansen, M. E.
 Harmsworth, A. J.
 Haymes, Mrs. G.
 Hevey, W.
 Hills, Dr. Stewart

Hitchcock, J. C.
 Hocking, J.
 Hughes, F. V.
 Hurdsfield, W.
 Hutton-Jones, Mrs.

John, Mrs. M. W. B.
 John, M. W. B.

Kennedy, D.
 King, G.

Langford, F. B.
 Lauriston, W.
 Learmonth, D.
 Little, Mrs. W. G.
 Lucas, A.

Maddern, Mrs. T. H.
 Malin, Mrs. H.
 Mapleson, J.
 Matthews, Mrs. H.
 Maxwell, Miss L.
 Mitchell, Dr. J. T.
 Montgomery, J.
 Morgan, Mrs. L. A.
 Morrison, M.
 Moss, Miss O.
 Moule, A. E.
 Munro, R.
 Moyle, S. T.
 Murphy, Mrs. W.

McCulloch, J.
 McGuigan, J.
 McKay, Mrs. J.

Norton, H.
 Nuffield, Lord

O'Haire, Mrs. J. S.
 O'Hehir, J.
 Owen, H. I.

Paddle, L.
 Parke, A. S.

Paterson, Mrs. W.
 Pinnock, Mrs. R. D.
 Poynton, V. C.
 Price, E. F.

Reynolds, W.
 Rice, J.
 Robertson, D.
 Robertson, J. V.
 Robertson, W.
 Rowe, Mrs. H. E.
 Russell, Major Philip

Sharp, A.
 Simpson, R.
 Sinclair, J.
 Sloss, Dr. W. A.
 Smart, J. P.
 Smith, H.
 Stevenson, I.
 Stewart, D. G.
 Stewart, J.

Tatham, F. S.
 Taylor, Mrs. A. J.
 Thomas, S. D.
 Thompson, J.
 Trist, D. G.
 Trinder, T.
 Tunbridge, R. J.

Vallance, Mr.

Ward, J.
 Wallace, T. B.
 Watson, J.
 Watson, W. R.
 Webster, G.
 Weickhardt, F. W.
 Weickhardt, Mrs. F. W.
 White, Mrs. H.
 Williams, G.
 Wilson, J.
 Woods, A.
 Wright, W. J.

Young, L. G.

List of Contributions

Abraham, E., £1/1/-; Abraham, Isaac Pty. Ltd., £1 1/-; Abraham, S., £2/2/-; Adams, Herbert Ltd., £5/5/-; Aikins, W. A., £1/1/-; Aisbett, R., £5; Alexander, Dr. D. A., £2/2/-; Alexander, S., £2; Allan, J. W., £2/2/-; Allan Bros., £1/1/-; Ampol Petrol Co. Pty. Ltd., £1/1/-; A.N.A., No. 4, £1/1/-; Ardern, C., £6; Andre, Mrs. M. W., £1/1/-; Andrews, E. W., £1/1/-; Andrew, Jack, Dyson & Co., £4/4/-; Andrewartha, F., £1/1/-; Angow, F. E., £1/1/-; Argyle Hotel Collection Box, £2/12/-; Aronson, D. & A., £1/1/-; Ashkar, A., £1/1/-; Ashley, W. W., £1/1/-; Aust. & New Zealand Bank Collection Box, £3/7/6; Aust. & New Zealand Bank, £7/7/-; Aust. Estates Co. Ltd., £3/1/2; Aust. Exhibition Commn., £2 2/-; Aust. Merc. Land & Finance Co. Ltd., £3/1/2; Aust. Tramways & Motor Omnibus Employees, £1/1/-; Avago, Miss L., £2; Anonymous, £1; Anonymous, £1; Anonymous, £50.

Bailey, J. E., £1; Baird, D., £2/2/-; Bayer, Dr. B. A., £1/1/-; Ballan Masonic Lodge, No. 205, £1/1/-; Ballan Shire Council, £20; Ballarat Bankers' Social Club, £2/2/-; Ballarat Banking Co. Ltd., £3/3/-; Ballarat Bowling Assn., £3/3/-; Ballarat Brewing Co. Ltd., £5/5/-; Ballarat Broadcasters Ltd., £25; Ballarat Broadcasters Ltd. (Proceeds Swallows' Concert), £17/5/-; Ballarat Charity Sunday Fund, £135; Ballarat City Council, £200; Ballarat "Courier," £2/2/-; Ballarat "Courier" Social Club, £1/1/-; Ballarat Fidelity Club, £2/2/-; Ballarat Gas Co., £3/3/-; Ballarat High School Social Service League, £15/15/-; Ballarat Mark Lodge, No. 114, £2 2/-; Ballarat Meat Stores, £2/2/-; Ballarat Modern Dairy, £2/2/-; Ballarat Steam Laundry, £1/1/-; Ballarat Theatres Ltd., £2/2/-; Ballarat Trades & Labour Council, £1/1/-; Ballarat Travellers' Social Club, £1,742/9/8; Ballarat Water Commissioners, £3/3/-; Ballarat Woollen & Worsted Co., £5/5/-; Bank of New South Wales, £5/5/-; Barlow, Mr. & Mrs. H., £2/2/-; Barnes, F. W. & Sons, £2/2/-; Barnett, H., £10; Barnett, H., £1/1/-; Bartrop, E., £1/1/-; Batt & Lyons, £1; Battye, H. Late, £1/11/-; Baxter & Stubbs, £1/1/-; Bayley, S., £1/1/-; Bayns, Mr., £1/1/-; Beacham, Mrs. E., £1/1/-; Beanland, M. & Son, £1/1/-; Beaumont, R. & A., £1/1/-; Beaupaire Tyre Service, £2/2/-; Bell & Shorten, £1/1/-; Bennett, F., £1; Bennett, Mrs., £2; Bennett, J. F. & Co., £1/1/-; Bennett, Miss L., £1; Benson, J., £1/1/-; Bentley, Mr., £10; Berlei Pty. Ltd., £1/1/-; Berlyn, I. & Son, £1/1/-; Bernard, A., £1/1/-; Berry, Anderson & Co. Ltd., £1/1/-; Besemeris, J. C., £2/2/-; Bettles, J., £1/1/-; Bird, G. M., £2/10/-; Blackman, L. A., £1/1/-; Blair, Miss J., £1/1/-; Blomeley, C. A., £2/2/-; Blomeley & Jones, £1/1/-; Blister, G. W., £1/1/-; Bolster, J., £1/1/-; Bolster, R., £2/2/-; Bongiorno, A., £1/1/-; Bracks Bros., £1/1/-; Bray, C. C., £1/1/-; Brennan, Estate late P., £30; Brighton Tech. School, £5 5/-; Bromley, Mr. & Mrs., £5; Brooks, McGlashan & McHarg, £2/2/-; Brophy, Foley & Co., £1/1/-; Brown's Cream & Red Hardware Store, £2/2/-; Brown, Harry & Co., £2/2/-; Brown, J. H. & Sons, £1/1/-; Brown, Mrs. L., £2; Brown, Ronald, £1/1/-; Brown's Confectionery Ltd., £2/2/-; Brudenell, H., £1/1/-; Bryant, H. E., £1/1/-; Bryant & Gourley, £1/1/-; Buchanan, Mrs. J., £1; "Bullfrog," £1/1/-; Buringong Lodge No. 23, £5/5/-; Bungee Shire Council, £15; Burns, Philp & Co. Ltd., £1 1/-; B. & W. Farmers' Co-Op. Ltd., £1/1/-; Burton, Roy & Co. Ltd., £6/6/-; Butler, A., £1/1/-; Byrne, T. E. & Co., £1/1/-;

Cadbury, Fry, Pascall Ltd., £1/1/-; Caddy & Kerr, £1/1/-; Cake Kitchen, £1/1/-; Caine, Dr. G., £1/1/-; Calaby, Mrs., £1/1/-; Caltex Ltd., £2/2/-; Cameron, M. F., £1/1/-; Cameron, J. B. & Co., £1/1/-; Cameron, Mrs. K. G., £20; Campbell, Late J., £50; Carey, L., £1/1/-; Carthew, F., £1/1/-; Cartledge, T., £10; Casualty Donation Box, £11/3/5; Cates, G., £1/1/-; Central Furniture Factory, £1; Chamber of Mfrs. Ins. Co., £30; Chambers, G. & W., £2/2/-; Chandler, D. & W., £1/1/-; Charles, G., £1/1/-; Charles, J. L., £1; Charrres Pty. Ltd., £1/1/-; Christopher, James & Elshaug, Misses, £2/2/1; C.E.B.G.S., £1/1/-; C.I.G. LTD., £3; Cincotta, C., £1/1/-; Clamp, C., £1/1/-; Clairmonte, Mrs. M., £1/1/-; Clark, G., £2 2/-; Clarke, Mrs. A., £1; Cleland, J. E., £1; Coad, E. A., £5/5/-; Coburn, H. L., £1/1/-; Cochran, E. B., £1/1/-; Cochran, W. L., £1/1/-; Cockings Pty. Ltd., £2/2/-; Coffield, T., £1/1/-; Coghlan, C. L., £3/3/-; Coghlan, Mrs. E. R., £1/1/-; Coles, G. J. & Co. (Ballarat), £2/0/5; Coles, G. J. & Co. Ltd., £25; Coliseum Motors Pty. Ltd., £2/2/-; Collins, A. H., £1/1/-; Collins, E., £1/1/-; Collins, M., £1; Collins, T., £1/1/-; Colman, W. F., £1/1/-; Comer, T. A., £2; Commercial Bank of Aust., £2/2/-; Commercial Banking Co. of Sydney Ltd., £3/3/-; C.T.A. of Vic., £7; Conaughton, J. P. & Co., £1 1/-; Congregational Church, £3/3/-; Cook, E. A. Pty. Ltd., £1/1/-; Cook, Mrs. F., £2; Cooke & Co., £1/1/-; Corbet & Scott Pty. Ltd., £3/3/-; Corbet, J. B., £2/2/-; Cornell, W. & Sons, £5/5/-; Coster, G., £2/2/-; Coulson, E., £2/2/-; C.W.A. (Ballarat Branch), £25; Cowan, Alex. (Aust.) Ltd., £1/1/-; Cowley's Eureka Ironworks, £1/1/-; Cox Bros. Ltd., £1/1/-; Coyne, Miss, £1/1/-; Craig Bros., £1/1/-; Crawford Dowling Pty. Ltd., £1/1/-; Cream Top Taxis, £1/1/-; Creswick Shire Council, £10; Cripps & Deveson, £1/1/-; Crocker, Geo. Pty. Ltd., £1/1/-; Cromie, Dr. G. P., £1/1/-; Crompton, N. F., £1; Crosswhite, G., £1/1/-; Curnow, S. R., £1/1/-; Currie, Lady, £10; Curwen-Walker, J., £1/1/-; Cuthbert, Morrow, Must. & Shaw, £1/1/-;

Dale, J. V., £1/1/-; Dalgety & Co. Ltd., £1/1/-; Darling, Smith Pty. Ltd., £1/1/-; Daniel, J. L., £1/1/-; Danks, John & Son, £3/3/-; Davey's Confectionery Works, £1/1/-; Davidson, G. R., £6/6/-; Davies, Dr. E., £1/1/-; Davies, F. T., £2/2/-; Davies, Harry & Co., £2 2/-; Davies, N. L., £1/1/-; Davies, W., £1/1/-; Davis, H. A. Pty. Ltd., £1/1/-; Day, E. E. & Sons, £1/1/-; Dearden, J. C., £2/2/-; Dellaca, J. A., £1/1/-; Delmer, Mrs. H. A., £2; Deutscher, H. F. & Son, £1/10/-; Dick, Drs. J. C. & H., £2/2/-; Dick, W. & Sons, £1/1/-; Dickinson, R. S., £1; Dickinson, Mrs., £1/1/-; Ditchfield, Miss A. V. J., £1/1/-; Ditchfield, C., £1; Dobbin Bros., £1/1/-; Doepel, Lilley & Taylor, £2/2/-; Doodt, N., £1/12/-; Downer, T. & Co., £5/5/-; Doyle, F. J., £1; Draffin, G., £1; Driscoll, Melvor & Co., £2/2/-; Drury, H., £1/1/-; Duncan, F. E. V., £1/1/-; Dunstan, H., £1/1/-;

Eagleton, Mrs. M., £1/1/-; Eastern Joinery Works, £1/1/-; Eaton, R., £10; Economic Ins. Co., £1/1/-; Eddy, J., £1; Eddy, J. L., £1; Edward, R. W., £2/2/-; Edwards, W., £4/10/-; Elliott & Magill Pty. Ltd., £2/2/-; Ellis, Mrs. B., £2; Ellis, Keith & Son, £2/2/-; Ellsworth, Cr. H. C., £1; E. S. & A. Bank, £3/3/-; Eureka Dry Cleaners, £1/1/-; Eureka Sawmill & Timber Co., £2/2/-; Eureka Valve Mfrs., £1/1/-; Evans, H. C., £1/1/-; Evans, H. & Son, £1/1/-; Evans & Metcalfe, £1/1/-; Ewins, J. Pty. Ltd., £1/1/-; Exchange Service Station, £2/2/-; Eyres Bros., £3.

List of Contributions—continued

Fairbairn, C. O., £10; Fargher & Roff, £1/1/-; Faulkner, F. M., £2/2/-; Faul's Shoe Store, £1/1/-; Favaioro, F. J. A., £1/1/-; Fawcett, A. D., £4/4/-; Feltham, J. C., £1/1/-; Felton, Estate of late A., £200; Fenton, Mrs., £1/1/-; Ferguson, A. C., £1/1/-; Fidelity Trustee Co., £1/1/-; Fiery Creek Lodge, No. 157, £2/2/-; Finch, L. H., £1/1/-; Firms, S., £1/0/6; Fitridge, Mrs. E. E., £2; Fitzmaurice, T., £1/1/-; Foo, A., £1/1/-; Ford Motor Co. Pty. Ltd., £25; Forrest, C. L. Trust, £8; Foy & Gibson Pty. Ltd., £3/3/-; Fricot, Mrs., £10.

Gair Manuf. Co. Ltd., £3; Gale, Mrs. F. C., £1/1/-; Garden City Flour Mill, £2/2/-; Gardiner, Mrs. H. E., £2/2/-; Garlick, G. W., £1/10/-; Gay, G. & Co., £1/1/-; George Hotel, £1; Gemmola, V., £1/1/-; George, H. B., £1/1/-; George, Miss K., £1/1/-; Gilbert, G. A., £1/1/-; Gilbert, J. B. & Son, £1/1/-; Gillett, R. L., £1; Glaxo Laboratories Ltd., £3/3/-; Goldsborough, Mort & Co., £3; Goller, J. J. & Co., £5/5/-; Gooch, W., £1/1/-; Goodfellow & Co. Pty. Ltd., £1/1/-; Gough, Dr. R. J., £1/1/-; Gower's Hosiery House, £1/1/-; Graham, Mrs. F., £1/1/-; Graham, R. & Sons Pty. Ltd., £2/2/-; Grand United Order of Oddfellows, £2/2/-; Gray, Miss E. A., £1/1/-; Greed, E. C., £1/1/-; Greed, Mrs. O., £3; Green, H. A. Motors, £1/1/-; Greenfields Pty. Ltd., £2/2/-; Gribble, Holloway & Heinz, £1/11/6; Gribble, W. & Co. Ltd., £1/1/-; Griffiths, Dr. P., £1/1/-; Griffiths, J. J., £1/1/-; Griffiths, W. R., £1/1/-; Grigsby, J., £1/1/-; Grigsby, L. J., £1/1/-; Gullan, J. C., £1/1/-; Gunn, L. M., £1/1/-; Gunn, W., £1/1/-; Gurton Tyre Co., £1/1/-; Guymer, Dr. E., £2/2/-; Guymer, F. E., £2/2/-.

Hager & Rawlings, £1/1/-; Hall, G. & Son, £1/1/-; Hames & Woodward Pty. Ltd., £1/1/-; Hamilton, E., £1/1/-; Hancock, A. W. & Co., £1/1/-; Hancock, Est. of V. M., £5; Handbags & Novelties, £1/1/-; Hannah, B., £2/2/-; Hanrahan, Mrs. W., £1/1/-; Harratt, L., £1/10/-; Harris, Miss E. A., £1/1/-; Harris, M., £1/8/-; Harrison, A. B., £1/1/-; Harrison, Mrs., £1/1/-; Hartley, Est. of late J., £70; Hatfield, A. W., £2; Hayden, B. E. & Co., £1/1/-; Hayes, J., £1; Haymes, Henry Pty. Ltd., £1/1/-; Headlam, J. S., £1/1/-; Healing, A. G. Ltd., £2/2/-; Heath, A. F., £2/2/-; Heather, H. W., £1/1/-; Heather's Frock Salon, £1; Heinz Bros. Pty. Ltd., £2/2/-; Heinz, J. H., £2/2/-; Hemingway & Robertson Pty. Ltd., £1/1/-; Henderson, Alex. & Son, £1/1/-; Henderson, H. J., £1; Henderson, A. & A., £1/1/-; Henderson, P., £9; Herald & Weekly Times Ltd., £5/5/-; Herbert, W. F., £1; Herman, F., £2/2/-; Hewitt, H., £1/1/-; Hewitt & Whitty Pty. Ltd., £1/1/-; Hicks, G., £1/1/-; Hillman, J., £5/5/6; Hobson, S. E., £2/2/-; Hocking, I., £5/5/6; Hodder, H. H., £1/1/-; Holdensen & Neilson Pty. Ltd., £2/2/-; Holloway, J. & Sons, £1/1/-; Homecrafts Pty. Ltd., £1/1/-; Hon, B., £2/2/-; Hooper, Mrs. N., £1; Hope Lodge, No. 274, £2/2/-; Horbury, Mrs., £2; Hoskin, J. A. & Son, £2/2/-; Howard Duncan Pty. Ltd., £1/1/-; Howard Smith Ltd., £2/2/-; Howell, R. C., £10/10/-; Howie, F. S., £1/1/-; Huddart, Parker Ltd., £1/1/-; Hudson, R. A., £1/1/-; Hughes, T. & Sons, £1/1/-; Humphreys, R., £2/2/-.

Ideal Dairy Pty. Ltd., £2/2/-; Imperial Chemical Industries, £6; Insurance Office of Aust., £1/1/-; Irish, G. & Sons, £6/11/6; Irwin, H. B., £1/1/-; Ind. Order of Oddfellows, £3/3/-.

Jago's Shoe Store, £1/1/-; James, Dr. G. T., £1/1/-; James, M., £1/1/-; Jelbart Bros., £3/3/-; Jenkins, E. & W. Bros., £1/1/-; Jenkins, C., £2/2/-; Jenkins, J., £1/1/-; Jenkins, Dr. W., £2/2/-; Jephson & Co., £1/1/-; Jephson, H. H., £2/2/-; Jermyon, R., £1/1/-; Jess, J., £2/2/-; John, Mrs. B. A., £5/5/-; John, D. L., £1/1/-; John, I. R., £1/1/-; John, J. T., £1/1/-; John, M. B., £1/1/-; John, M. B. Pty. Ltd., £5/5/-; John, M. B. Charities Group, £50; Johnson, Rt. Rev. W. H., £1/1/-; Jones, W., £1/1/-; Joshua, R., M.H.R., £1/1/-; Junior Chamber of Commerce, £45.

Keath, V. E., £1/1/-; Keighery, Miss, £3; Kennedy, F. J., £1/1/-; Kennedy, J. M., £1/1/-; Kennedy, Murray Proprietary Limited, £1/1/-; Kent, George, £1/1/-; Kierce, J., £1/1/-; King, Alex. & Sons Pty. Ltd., £1/1/-; King, C. H., £1; King & George Motors, £1/1/-; King, R. A., £1/1/-; Kinneburgh, R., £5; Kitcher, R., £1/1/-; Kittson, J. F., £1/1/-; Knight, M. & Son, £1/1/-; Knowles, Mrs., £5; Kodak (Aust.) Pty. Ltd., £2/2/-; Kuchel, Mrs., £1/1/-.

Labbett, E., £3/3/-; Labbett, Mrs. F., £1; Lamond, L., £1; Lancashire, R. H., £1/1/-; Lance & Yorke, £1/1/-; Lawler, Miss K. C., £10; Lawrence, Alfred & Co. Pty. Ltd., £1/1/-; Learmonth Lodge, No. 177, £2/2/-; Leigh Shire Council, £5/5/-; Lemke, Geo. & Co., £1/1/-; Leviston, A., £1/1/-; Leviston, L. & F., £1; Lexton Shire Council, £3/3/-; Lidgett, T., £2; Lifeguard Milk Co. Employees, £3; Lister, E., £2/2/-; Liston, W., £1/1/-; Liverpool, London & Globe Ins. Co. Ltd., £1/1/-; Lock, W. E. G., £1/1/-; Lockett, Howard & Sons, £1/1/-; "Lorel" Cafe, £5/9/6; Lowery & Murphy, £1/5/6; Loyal Ballarat Lodge, No. 20, £1/1/-; Lucas, E. & Co. Pty. Ltd., £10/10/-; Ludbrook, E. G., £1/1/-; Ludbrook, H. C., £1/1/-; Ludbrook, S. & Sons, £1/1/-; Luke, K. G. (Aust.) Ltd., £2/2/-.

Mackay, K., £1/1/-; MacLeod, J. & Co., £1/1/-; MacRobertson's Pty. Ltd., £1/1/-; Macdonald, W. B., £1/1/-; Mac's Garage, £1/1/-; Maddern, H. R., £1/1/-; Maddern, L., £2/2/-; Maddern, W., £3/3/-; Marks, C. & Co., £1/1/-; Mark & Philp Pty. Ltd., £1/1/-; Mark's Motor Service, £1/1/-; Marland Motors, £1/1/-; Maroney, F., £1/1/-; Martin, Mrs. J., £50; Martin Bros., £1/1/-; Mary-Helen Auxiliary, £418/4/6; Mather, Mrs. F., £1/1/-; Matthews Bros., £1/1/-; Mayes, E. P., £1/1/-; Meeney, Miss V., £1; Melbourne Woolbrokers' Assoc., £12/6/1; Mende, E. H., £1/1/-; Menhennett, F., £1/1/-; Meredith Hotel Collection Box, £6/18/2; Messer & Opie, £2/2/-; Messer, Mr. and Mrs. W., £5; Metz, M., £2/2/-; Michaelis, Hallenstein Pty. Ltd., £1/1/-; Middleton & Morris, £1/1/-; Mill, L., £1/1/-; Miller, A., £1; Miller, A. K., £1/1/-; Miller, A. W., £1; Miller Bros. Ironworks, £1/1/-; Miller, P. J., Estate of, £1/1/-; Millers The Clothiers, £1/1/-; Mitchell, J., £1; Mitchell, R., £1/1/-; Mitchell, Mrs. R., £1/1/-; Mong, Mrs. A., £1/1/-; Moran & Cato, £1/1/-; Morley, I. & R. Pty. Ltd., £2/2/-; Morris, N. E., £1; Morrison, G., £1/1/-; Morris & Walker Pty. Ltd., £2/2/-; Morrow, H. F., £1/1/-; Morrow, H. G., £1/1/-; Morshead's, £2/2/-; Mortimer, J. J., £1/1/-; Mottlake Shire Council, £5; Morton, E. R., £1/1/-; Mott, C., £2/2/-; M.U.I.O.O.F. (Ballarat), £2/2/-; Mulgrew, B. J., £1/1/-; Murphy, D., £1; Musgrove, A., £1/10/-; Must, R. A., £101/1/-; Myer Emporium (Ballarat) Pty. Ltd., £5/5/-.

List of Contributions—continued

McArdle, Dr. F. P., £1/1/-; McArthur, C., £3/3/-; McClymont, Mrs. R., £1/1/-; McDonald, C., £2; McDonald, J., £2; McDonald, L., £1/11/6; McDougall & Chisholm, £1/1/-; McFadyen & Taylor, £1/1/-; McFarlane, E., £3; McFarlane, Mrs. E., £3; McGregor, A., £20; McLvor, S. K., £1/1/-; McKay, H. V., Massey-Harris, £2 12/6; McKay, J., £2/2/-; McKay, J. & Sons, £3/3/-; McKnight, W., £1/1/-; McLachlan, Mrs., £3; McLean & Boakes, £1/1/-; McLeod, R., £1/1/-; McPhee, Mrs., £1; McPherson, J. C., £1/1/-; McPherson's Pty. Ltd., £5; McRae, Mrs. C. S., £1/1/-.

National Bank of Aust., £3/3/-; Neptune Oil Co. Ltd., £2/2/-; Nestle's Food Specialties (Aust.) Ltd., £1 1/-; Nevett, Nevett & Glenn, £1/1/-; New Zealand Ins. Co. Ltd., £1/1/-; Nicholas Pty. Ltd., £5; Nichols, A. H., £1/1/-; Nicholson, A. W., £2/2/-; Nicholls, W. J., £1; North-Western Fruitgrowers, £3/3/-; North British Ins. Co., £2/2/-.

Oakman, Mrs., £5; O'Collins, Most Rev. Dr., £1/1/-; O'Connor, Mrs. E. H., £1/1/-; O'Donnell, J. & E. M., £1 1/-; O'Halloran, Miss, £1/1/-; Oliver & Stevens, £1/1/-; O'Loughlin, C. J., £1; O'Meara, E. A., £2; Opie, F., £3 3/-; Opie, Mrs. L., £1/1/-; Orion Lodge, No. 53, £2/2/-; Orr, G. E., £1/1/-; Osborne, Mrs., £5; Ovo Pty. Ltd., £1/1/-; Owen, Cr. J. F., £1/1/-; Oxbrow & Co., £1/1/-.

Palmer, W. A., £2/2/-; Parker & Chamberlain Pty. Ltd., £1/1/-; Parker, G., £1/1/-; Parry & Son, £1/1/-; Pascoe, T. & Son, £1/1/-; Paton & Baldwin Ltd., £5; Payne, Mrs. P. M., £3; Pearce, Mr., £3/3/-; Past Trainees' Assoc., £134/17/3; Pearce, Mrs. M., £3/3/-; Pennant, C. W., £1/1/-; Penney, J. & Sons, £1/1/-; Perkins, W. J., £1/1/-; Perrin, Dr. G., £1/1/-; Pescott, Dr. N., £1/1/-; P.H., £1; Phillips, Mrs., £1; Phillips' Elec. Industries, £2/2/-; Phillips, R. K., £10; Philmore's Pty. Ltd., £2/2/-; Philip, B., £1/1/-; Picot & Widmer, £1/1/-; Pittard, Cr. A. C., £1/1/-; Pittard, Mrs. A. J., £1/1/-; Pizey, Geo. & Sons, £1/1/-; Pleasant St. S.S., £10; Plover, G., £1; Pope, C., £2/2/-; Poulton, A. W., £1/1/-; Pratt, D. & Sons, £1/1/-; Price, J., £2/2/-; Prince of Wales Lodge, No. 40, £2/2/-; Printing Industry Employees, £1 1/-; Provincial Motors, £2/2/-; Pryor, J., £1/1/-; Pryor, Dr. W. A., £1/1/-; Punshon, G. L. & Son, £1/1/-.

Quayle & Hutton, £1/1/-; Queen's C.E.G.S., £1 1/-.

Ramsay, R. H., £1/1/-; Rasmussen, Miss, £1; Re Bros., £1/1/-; Reams, H. W., £1; Redan Old Scholars' Assoc., £2/2/-; Redemptorist Fathers, £1/1/-; Redman, J. H., £1/1/-; Reeve, E. J., £1/1/-; Rehfsch, H. & Co., £1/1/-; Reid, J. & Sons, £2/2/-; Remington & Trethowan, £1/1/-; Reynolds, H. V., £1/1/-; Reynolds, R. L., £10; Richards, D., £5; Richards, P. R., £1/1/-; Richards, W. L. & M. C., £2/2/-; Richardson, Dr. C. E., £1/1/-; Rimmington Bros., £1/1/-; Ritchie, Mrs. J., £1; Ritchie, R., £1/1/-; Ritchie, W. Pty. Ltd., £1/1/-; Rizzoli, L., £1/1/-; Roberts, Dr. G., £1/1/-; Robertson, Mrs. E. J., £1/1/-; Robertson, J. V., £1/1/-; Robinson Bros., £1/1/-; Robinson, Mrs. D., £1/1/-; Robinson, D., £2/2/-; Robinson, M., £1/1/-; Robinson, W. C., £1/1/-; Rocco Mondì, £2/2/-; Rock-

man's (Vic.) Pty. Ltd., £1/1/-; Rodda, W. J. Pty. Ltd., £2/2/-; Roddis, W. C., £1/1/-; Roff, W., £1/1/-; Roger David Pty. Ltd., £5/5/-; Raker, B. M., £1/1/-; Ronaldson Bros. & Tippett Limited, £5/5/-; Ronaldson Bros. Social Club, £2/2/-; Ross, K., £1/1/-; Rossen, E. J., £1/1/-; Rowe, C. & Sons, £1/1/-; Rowen, W. J. & Co., £1/1/-; Rowlands Pty. Ltd., £2/2/-; Royal Insurance Co., £3/3/-; R.S.S.A.I.L.A., £5/5/-; Russell, Est. of G., £10; Russell, P., £20; Russo, Miss C., £1/1/-; Ryan, L., £1; Ryan, J. P., £1/1/-.

Salter, Dr. and Mrs. A. C. H., £2/2/-; Saph, A. J., £5/0/6; Scarff, T., £1/1/-; Schrader & James, £1/1/-; Scott, E., £1/1/-; Scottish Hotel Collection Box, £3/1/-; Sebastopol Council, £3/3/-; Sebastopol Lodge, No. 63, £1/1/-; Selwood, Miss A., £1/1/-; Serjeant, Miss V. M., £1/1/-; Seventh Day Adventists, £4/8/-; Shane, Mrs., £1; Shaw, G., £1/1/-; Sheehan, J. J., M.L.A., £1/1/-; Sheers, Misses E. & F., £2/5/-; Shell, Dr. E. R. G., £1/1/-; Shell Co. of Aust. Ltd., £3/3/-; Shell Depot Employees, £8 1/-; Shillabeer, E. M., £1/1/-; Sicree, R. J., £3/3/-; Sim, R. & Co. Pty. Ltd., £1/1/-; Simpson, J., £1/1/-; Skewes, D. B., £2/2/-; Skewes, Dr. M., £1/1/-; Sloan, Mr., £1 1/-; Sloss, Dr. W. L., £2/2/-; Sloss, Dr. W. A., £2/2/-; Smerdon, A., £1; Smith, A. M., £1/1/-; Smith, H. E., £1/1/-; Smith, H. J., £2/2/-; Smith, J. Pty. Ltd., £1/1/-; Smith, Dr. P. G., £1/1/-; Smith, W., £1; Smythe, W., £1; Snow, M. J., £1; Snow's Mens' Wear, £4/4/-; South British Ins. Co., £1/1/-; Spiers, A., £1/1/-; Sprague, W., £1; Spring, J. W., £1; Stansfield & Smith, £2/2/-; State Savings Bank Collection Box, £4/19/9; State Savings Bank Staff, £2/2/-; Steele, T., £2/2/-; Stephens, Mrs., £3; Stephens, Mr., £2; Stevens, Dr. J. S. T., £1/1/-; Stevenson & Taylor, £1/1/-; Stewart, Mrs. C., £1; Stewart, Cr. G., £1/1/-; Stewart, L., £5; St. John's Lodge, No. 36, £2/2/-; Stone's Drapery Stores, £1/1/-; Strickland, E. J. & Sons, £1/1/-; St. Sidwell's Lodge, No. 168, £1; Stoddart, Miss E., £2/2/-; Stoddart, W. J., £1/10/-; Sturt and Drummond St. Service Station, £1/1/-; Sturt Dry Cleaners, £1/1/-; Sturt Lodge, No. 427, £2/2/-; Sutton, J. Kingsley, £1/1/-; Sunday School of the Air, £20; Sun News Pictorial, £5/5/-; Suttie, Mr., £5; Suttons Pty. Ltd., £2/2/-; Swallow & Ariell Ltd., £2/2/-; Swan, J. M., £1 1/-; Sykes, G., £1/1/-; Sykes, P. A., £1/1/-; Symes, Mrs. V., £1; Symons, H. J. Pty. Ltd., £1/1/-.

Taylor, Mr., £5; Taylor, C. Hall, £1/1/-; Taylor, F., £1; Taylor, G., £1; Taylor & Taylor, £1/1/-; Taylor, W., £5; Temby, Mrs. A. J., £1/1/-; Thiessen & Irvine, £1/1/-; Thomas, W. C. F. Charitable Trust, £75; Thornton, Richards & Co., £1/1/-; Thomas, D., £1; Thomas, J., £1; Thomas, Dr. J. E., £1/1/-; Thomas Supply Stores, £1/1/-; Thomas, W., £1; Thomas, W. C. & Co. Ltd., £10; Thompson, H. L., £1/1/-; Thompson, Mrs. W. D., £1/1/-; Thornton, Mrs., £1; Titheridge & Growcott, £1/1/-; Tinney Brothers & Hanrahan, £1/1/-; Tippett, H. C., £1/1/-; Tobin, N., £1/1/-; Todd, E. H., £1/1/-; Toshack, H. J., £5/5/-; Trahar Bros., £2/2/-; Travers, K. R., £1/1/-; Tregoning, H. Pty. Ltd., £5/5/-; Treleaven, W. J. K., £1/1/-; Troon, H., £1/1/-; Truswell, O., £1; Tunbridge, R. & Sons, £2/2/-; Turner, C. G. & Son, £1/1/-.

Vacuum Oil Co. Pty. Ltd., £3/3/-; Valentina, S. G. & Co., £1/1/-; Valpied, L., £1/1/-; Valpied, W., £1/1/-; Vawdrey, E. G., £1/1/-; Vernon, Mr. and Mrs. L. C., £1/1/-; Vickery, Miss L., £1/1/-.

Wain, A. S., £1/1/-; Walker, R., £1/1/-; Wallace, Millbrook Butter Co., £2/2/-; Waller & Chester, £2/2/-; Waller, L., £1/1/-; Waller, G. & E., £1/1/-; Wallis, R., £2 2/-; Walsh, B., £1; Walton, D., £1; Walton, W., Junr., £1/1/-; Wardrop My Tailor (Ballarat Branch), £1/1/-; Warren, Mrs. D., £6; Wastell & Cutter, £2/2/-; Wattle Tea Rooms, £1/1/-; Webb, L. & K., £1/1/-; Weir, S. J., £1/1/-; Wendouree Lodge, No. 336, £1/1/-; Wendouree Woollen Mill Proprietary Limited, £10/10/-; Wendt, V. Motors, £1/1/-; Were, J. B. & Sons, £10; Westcott, C., £1/1/-; White, A., £1/1/-; White, E. V., £1/1/-; White, H. M., £5/5/-; White, Joe & Co. Pty. Ltd., £65/15/-; White, J. H. D., £1/1/-; White, R. Pty. Ltd., £1/1/-; White, R. T., M.L.A., £2/2/-; White, W. H., £1; Wight, Mrs. G., £1/1/-; Wilding, E., £1/1/-; Wilkie, R. A., £4/0/11; Wilkins, A. W., £1; Wilkinson, J., £1/1/-; Williams, Mrs. A., £20; Williams, A. J., £2/2/-; Williams, D., £1/1/-; Williams, Miss G., £1/1/-; Williams, H., £1/1/-; Williams, J., £1 1/-; Williams, N., £2; Williams, R., £1/1/-; Williams, T. & F., Est., £100; Williams, Wavie, Pantomime Company, £63/5/9; Williamson, H. E., £1; Wills, W. D. & H. O. (Aust.) Ltd., £3/3/-; Wilson, D. R., £2/2/-; Wilson, F., £1/1/-; Wilson, M. S., £1/1/-; Wilson, Dr. S. A., £1/1/-; Wishart, Mrs. D., £31/1/-; Wishart, J. & A., £4/4/-; Wormald Bros. Ltd., £1/1/-; Wyres Bros., £1/1/-; Wyres, W. E., £2/2/-.

Yarrowee Lodge, No. 10, £2/2/-; York St. Church of Christ, £4/5/-; Young, C., £1/1/-; Young, R. K., £1/1/-; Yuille, Dr. M., £100.

The Hospital is frequently thought of when people are making Wills. Money thus made available assists tremendously in the development of the Hospital, and can be ear-marked for capital, maintenance or any specific purpose to meet the expressed wishes of the people concerned.

ENDOWED BEDS

Endowment of beds is gladly welcomed by the Committee of Management, and a word of explanation is submitted for the information of those who desire to perpetuate the memory of some person, organization or auxiliary.

A gift of £500 or more to the Hospital entitles the donor to a bed in perpetuity, and have a nameplate attached to the bed. The capital is invested and cannot be used, excepting the interest therefrom, which is devoted to maintaining the endowed bed.

Our endowed beds are as follows:

"FRANK PINKERTON"	£1500
"MARY-HELEN AUXILIARY"	£1000
"HELEN GARDINER"	£500
"JOHN ARCHIBALD FAMILY"	£500
"ISABELLA MAIN RIPPIN"	£500
"RAILWAY AUXILIARY"	£500
"TRAINED NURSES' LEAGUE"	£500
"FRANCIS ODDIE"	£500
"WILLIAM ANDREW GILMORE"	£500



.....

Much of that which has been achieved in the past, and in the year reviewed by this Report, would not have been possible but for local support, as distinct from Governmental assistance.

Quite apart from its value from a financial viewpoint, Ballarat and district support for the Hospital provides the stimulus and inspiration which, in fact, makes this—"The Ballarat and District Base Hospital"—YOUR Hospital.

Long may your close support and interest continue!